

Conference EVENTS & INCENTIVES

**SCENIC
HOTEL
GROUP**

NEW ZEALAND
OWNED &
OPERATED



INNER CITY STYLE IN THE HEART OF DUNEDIN

Located in the central city, the Scenic Hotel Dunedin City is a contemporary property of award winning design. This stylish hotel incorporates clean lines, attractive local artworks, and dramatic features that are softened with natural elements including timber, cedar venetians, and neutral tones.

Many of the spacious guest rooms offer views of the city or harbour, while the street-side Princes on Dowling Restaurant is the perfect central city location. Our lounge bar is a great place to relax, and is just a short walk from the Octagon, Railway Station, and shopping.

CONTACT US

Scenic Hotel Dunedin City

Corner of Princes and Dowling Streets,
PO Box 618, Dunedin 9054

E: dch@scenichotels.co.nz
0800 NZ OWNED (69 69 63)

www.scenichotelgroup.co.nz



For more information and to book, visit
scenichotelgroup.co.nz/DCH-functions



OTAGO DUNEDIN

Called the 'Edinburgh of the South', Dunedin is New Zealand's oldest city and traces its history back to its Scottish settlers. It boasts a unique combination of cultural riches, fine architecture, and world-famous wildlife reserves on the Otago Peninsula.

Dunedin is fast becoming known for its incredible fashion, street art, and artisan values, and with the eclectic vibes of the student life mixed with a bustling business district and traditional heritage, there is a wide range of experiences on offer.

KEY LOCATIONS CLOSE TO OUR HOTEL

- City Centre 200m
- Dunedin Public Art Gallery 230m
- Otago Museum 1.6km
- Larnach Castle 13.5km
- Airport 28km



SCENIC HOTEL DUNEDIN CITY

This stylish inner-city hotel is in the ideal location to discover all that Dunedin has to offer.

Flooded with natural lighting and soft, contemporary detailing. With our spacious guest rooms, modern facilities, and attractive local artworks, Scenic Hotel Dunedin City presents a relaxing yet chic setting for business and leisure travellers.

- Check in time: 2:00pm
- Check out time: 10:00am
- Princes on Dowling Restaurant
- 24 hour reception
- Two guest laundries
- Valet laundry and dry cleaning service
- Gym
- Free WiFi throughout the hotel
- Business services
- Car Parking. Booking essential for on-site parking. Alternative options available within a short distance from the hotel

Special accommodation rates apply to our conference clientele and we will be delighted to include these great rates in your conference quotation.



ACCOMMODATION OPTIONS

Our Dunedin Hotel accommodation guest rooms and suites offer good natural lighting with modern styling. Executive rooms and suites all feature a private balcony, and selected rooms have harbour or city views. All rooms and suites include air conditioning, 50" Smart TV capable of casting your device, SKY TV, mini fridge, tea & coffee facilities, hairdryer, and free WiFi. Executive rooms and suites feature bathrobes, capsule coffee maker and executive work desk. There is an accessible bathroom option available in some rooms (on request and subject to availability). Interconnecting room options are also available on request.

STANDARD ROOM

29m² 1-2 1-3

SUPERIOR ROOM

31-35m² 1-3 1-4

EXECUTIVE ROOM

30m² 1-2 1-4

EXECUTIVE SUITES

47-60m² 1-3 1-5

CONFERENCE CAPACITY CHART

Room Layout



Theatre

40



Classroom

24



U Shape

26



Board Room

24



Hollow Square

30



Cocktail

40

Highland Room

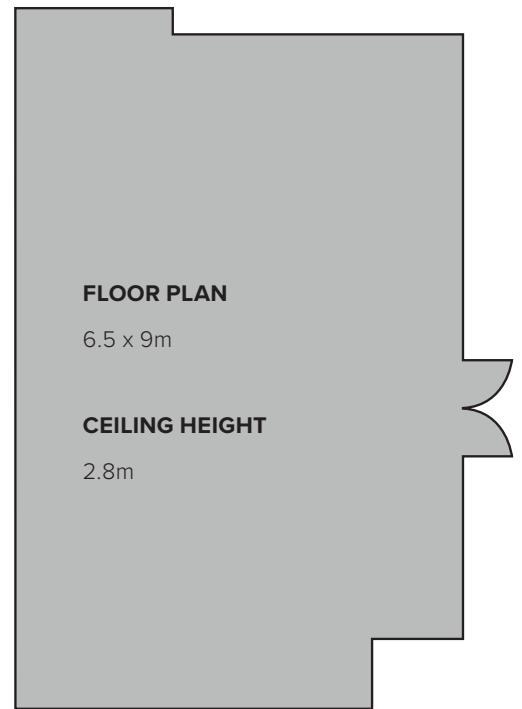



VENUE DETAILS

HIGHLAND ROOM FULL DAY

\$500 / DAY

- The Highland room is situated on the ground floor with its own street entry. It is fully air-conditioned and excellent for a wide range of events

DAILY DELEGATE RATE

\$60 PP

- Minimum 10 delegates
- Includes: Conference room hire, basic equipment (flip chart, whiteboard, and pens), morning tea (one option), working lunch, and Afternoon tea (one option).

EQUIPMENT HIRE & SERVICES

All conference rooms include the following set up: whiteboard, tables, linen, writing pads, pens, iced water, and mints.

Unlimited WiFi	Complimentary
Whiteboard	\$25
Flip Chart	\$25
75" Smart TV	\$150
Data projector	\$100
Screen	\$25
Lectern	\$25

Any items not listed can be obtained through an independent audio-visual supplier. Prices are per day, subject to application, and inclusive of GST.



COFFEE BREAKS

Freshly brewed coffee and a selection of teas

Served with **one** of the following **\$9.50 pp**

Served with **two** of the following **\$13.50 pp**

Served with **three** of the following **\$16.50 pp**

SAVOURY SELECTIONS

- Mini croissant with ham, brie, and tomato
- Smoked salmon and cream cheese on mini rye bread rolls
- Mini focaccia sandwich with hummus, grilled peppers, and zucchini
- Roast vegetable frittata with house-made relish
- Savoury scones with butter
- House-made pork, apple, and sage sausage rolls

SWEET SELECTIONS

- Mini chocolate and almond eclairs
- Scones with strawberry jam and cream
- A selection of home baked cookies
- Raspberry friands
- House-made sweet fruit muffins
- Fresh fruit bowl

SAMPLE MENU: menus will be finalised upon confirmation of the booking

***Dietary Information:** All meals are prepared in a facility using products containing allergens. Please advise the restaurant team of allergies or intolerances. Our chefs pride themselves on sourcing the freshest seasonal food and beverage, so menus are subject to change.*

WORKING LUNCH

WORKING LUNCH 1

\$29.50 PP

Ciabatta Sandwich

Filled with roast beef, lettuce, tomato and horse radish cream

Waldorf Salad

Apple, celery, toasted walnuts with a lemon cream dressing

Grilled Chicken

Boneless chicken breast marinated with garlic, lemon, and rosemary with a mushroom, red pepper, and basil sauce

Buttered Desiree Potatoes

Steamed baby red jacket potato finished with butter, chives, and cracked black pepper

Chocolate Brownie

With anglaise and whipped cream

WORKING LUNCH 2

\$29.50 PP

Finger Sandwiches

A selection of wholemeal and white finger sandwiches including vegetarian options

Thai Noodle Salad

Vermicelli noodles, mung sprouts, cucumber, peppers, and roasted peanuts with a sesame, lime, and coriander dressing

Honey Soy Pork

Pork shoulder marinated with ginger, garlic, and lemon, slow roasted until tender. Served with a honey soy sauce

Pilaff Rice

Braised basmati rice flavoured with curry and garnished with peas

Fresh Seasonal Fruit Platter

WORKING LUNCH 3

\$29.50 PP

Ham and Swiss on Rye

Shaved ham, Swiss cheese, lettuce, tomato and Dijon on light rye bread

Garden Salad

Baby lettuce leaves with cucumber, cherry tomato, and a balsamic dressing

Lamb Koftas

Grilled lamb mince kebabs seasoned with cumin, coriander, and paprika served with a minted garlic yoghurt

Lebanese Bulgur

Cracked bulgur wheat braised with tomato, red peppers, olives, currants, and saffron

Baked Ricotta Cheesecake

Flavoured with lemon and vanilla, served with a berry coulis

SAMPLE MENU: menus will be finalised upon confirmation of the booking

Dietary Information: All meals are prepared in a facility using products containing allergens. Please advise the restaurant team of allergies or intolerances. Please note all catering arrangements are served in the conference room. Lunch could be also served in the Princes On Dowling Restaurant on prior arrangements.



ACTIVITY DETAILS

Scenic Hotel Dunedin City has partnered with some great local operators to take your next conference or event to the next level.

From team building to easy activities or grand adventures, there are options for all. For more details or ideas contact one of our conference team.

Here is a taste of what there is to do in Dunedin and surrounds:

- Feel like royalty with a visit to Larnach Castle, the only castle here in New Zealand, which has been restored to its full Victorian grandeur
- Do the Dunedin Street Art Trail and see some of the incredible murals created by local artists as well as many from around the country and the world
- Be charmed by Port Chalmers, only around 20 minutes drive from the city. Visit local artists, musicians and jewellers, and take in the colour and vibrancy from one of the many cafes
- Satisfy your sweet tooth with some of the local Ocho Chocolate
- Embrace the architecture with some of the well preserved buildings built in the Victorian and Edwardian eras, giving it a feeling of history and heritage
- Catch a sporting match or maybe an international superstar at Forsyth Barr Stadium – the multipurpose and versatile arena – complete with roof to ensure all year round entertainment
- Get up close with nature at some of the various wildlife experiences around the region, from albatross, to Hoiho (yellow eyed penguin), fur seals, and dolphins
- Surf's always up at St Clair Beach! (just remember your wetsuit!)
- Don't forget the iconic photo opportunity and must do kiwi experience of a walk up Baldwin Street – officially the steepest street in the world!
- Take a trip to Orokonui Ecosanctuary, home to rare and endangered native birds
- Sample some of Dunedin's distilleries and breweries with guided tours and tastings

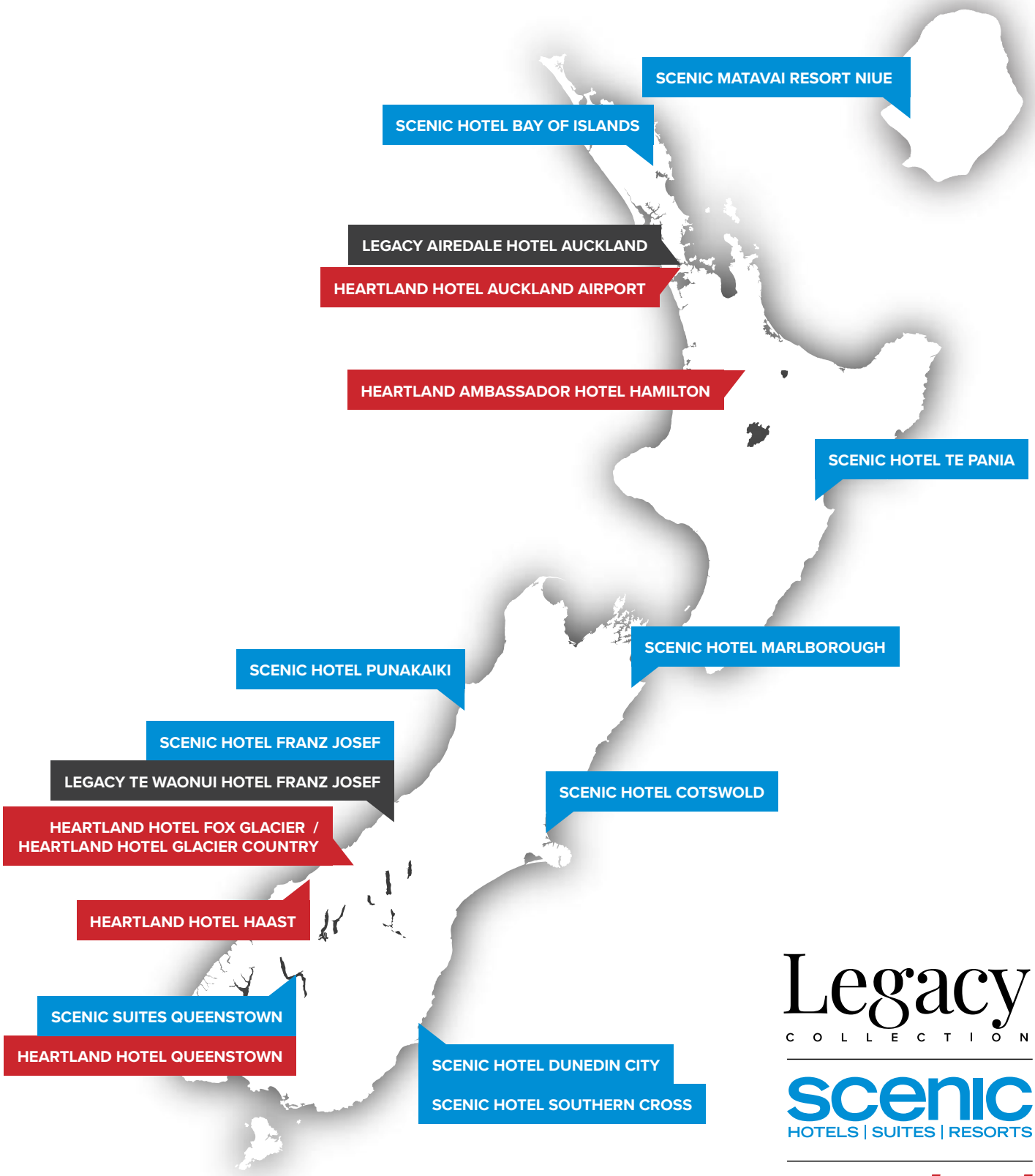

Legacy
COLLECTION

scenic
HOTELS | SUITES | RESORTS

Heartland
HOTELS

0800 69 69 63
scenichotelgroup.co.nz



WINNER OF THE
2024 ENVIRONMENTAL
PROGRAM AWARD

SCENIC
HOTEL
GROUP
NEW ZEALAND
OWNED &
OPERATED